



Jet Centro, 79 St. Marys Road, Sheffield, South Yorkshire, S2 4AU



An opportunity has arisen to purchase this beautifully presented one bedroom second floor apartment in the Jet Centro Development.

Being located in the City Centre and therefore close to all local amenities and transport links including the railway station and Super tram. Benefiting from electric heating, security intercom system, and integrated kitchen with appliances to include electric hob, extractor fan and electric oven.

The accommodation briefly comprises: communal entrance, lift access to first floor, entrance hallway, open plan lounge through kitchen, utility cupboard including separate washing machine and tumble dryer, bedroom and shower room being fitted with wash hand basin, low flush WC and shower cubicle having mains shower within.

This property would be ideal for home owners, and the property also proves to be an excellent investment for potential landlords. All furnishings are included in this sale. Chain Free.

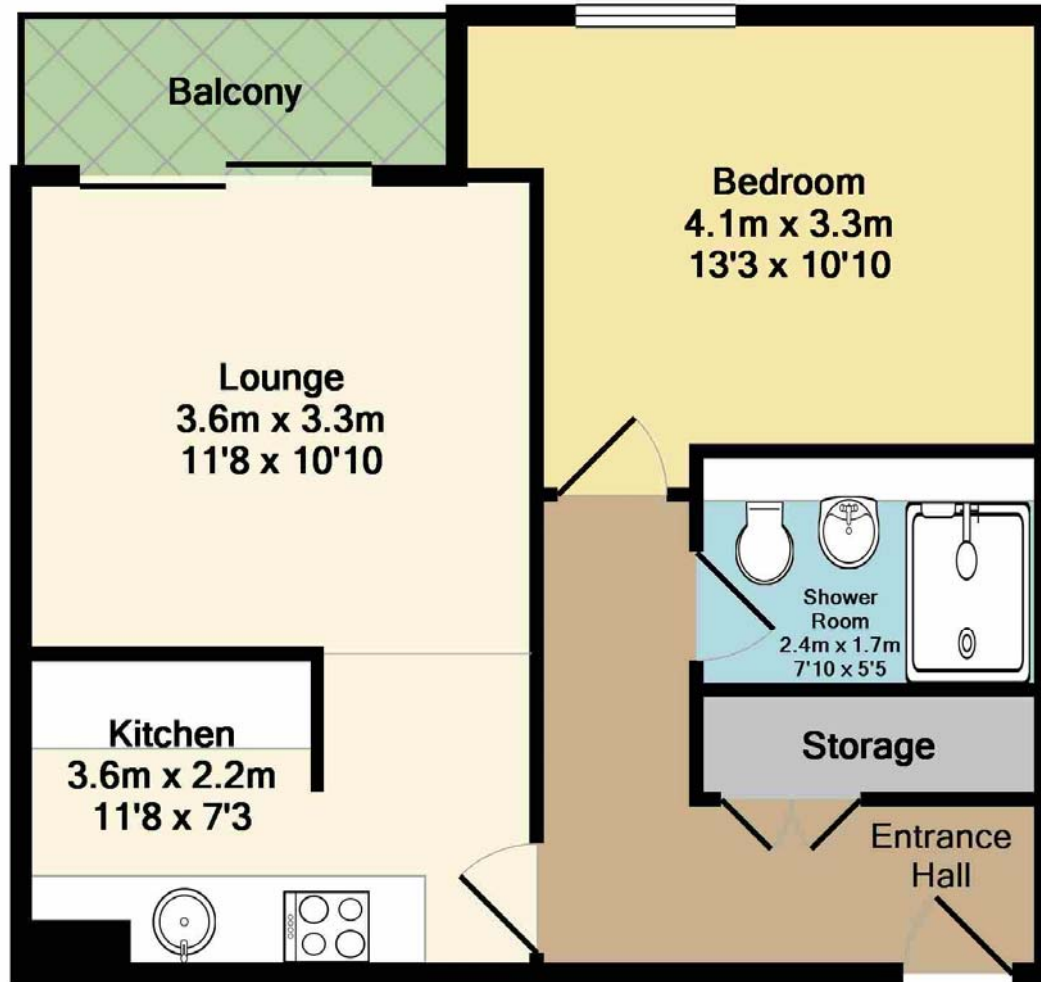

Total Approx. Floor Area 43.2 Sq.M. (465 Sq.Ft.)

Whilst every attempt has been made to ensure the accuracy of the floor plan contained here, measurements of doors, windows, rooms and any other items are approximate and no responsibility is taken for any error, omission, or mis-statement. This plan is for illustrative purposes only and should be used as such by any prospective purchaser. The services, systems and appliances shown have not been tested and no guarantee as to their operability or efficiency can be given

Made with Metropix ©2018



Viewing arrangement by appointment 0114 275 3853

[sales@blundells.com](mailto:sales@blundells.com)

2 Campo Lane, Sheffield, S1 2EF

[www.blundells.com](http://www.blundells.com)



Land & New Homes | Auctions | Mortgage Services | Surveys | Conveyancing

Interested parties should satisfy themselves, by inspection or otherwise as to the accuracy of the description given and any floor plans shown in these property details. All measurements, distances and areas listed are approximate. Fixtures, fittings and other items are NOT included unless specified in these details. **Please note that any services, heating systems, or appliances have not been tested and no warranty can be given or implied as to their working order.**

A member of Countrywide plc. Countrywide Estate Agents, trading as Blundells, registered office: Countrywide House, 88-103 Caldecotte Lake Drive, Caldecotte, Milton Keynes, MK7 8JT. Registered in England No. 789476 | Code: BlundellsEA\_CPL\_CPL180267\_PL4PL\_8

