

Patricia Gardens, Billericay, CM11 2QR

Asking Price £500,000

Bairstoweves



EPC **D**





SEVEN bedrooms! Loads of living space. Immediate viewing required!

Situated in a pleasant cul de sac within easy reach of local shops, bus routes, excellent local schools and offering no onward chain is this substantially extended SEVEN bedroom house! Ideally suited to a large or extended family, this house offers loads of living space and should be viewed without delay. The ground floor comprises of a 26ft lounge, 2nd reception and kitchen/breakfast room, with five bedrooms, an en suite and family bathroom to the first floor and a further two bedrooms and en suite to the top floor. Externally there is a laid to lawn rear garden, patio, side access with a block paved driveway to the front.



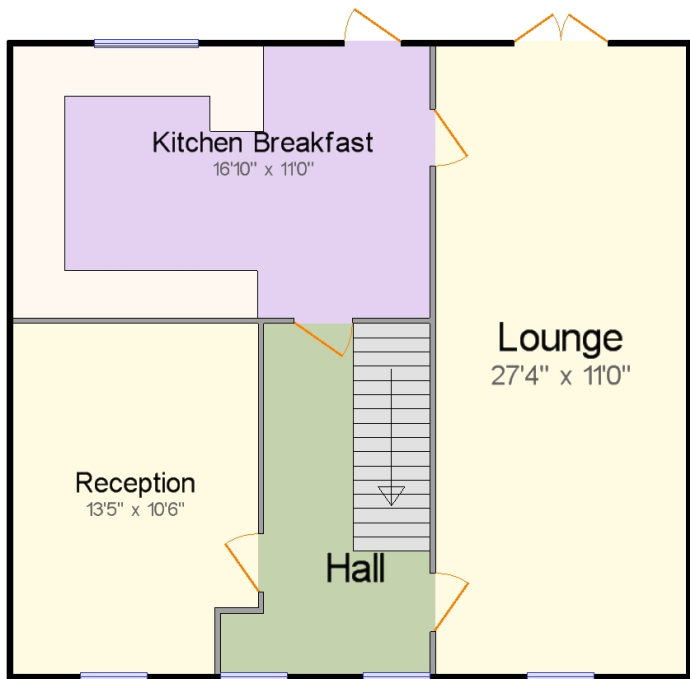

Ground Floor

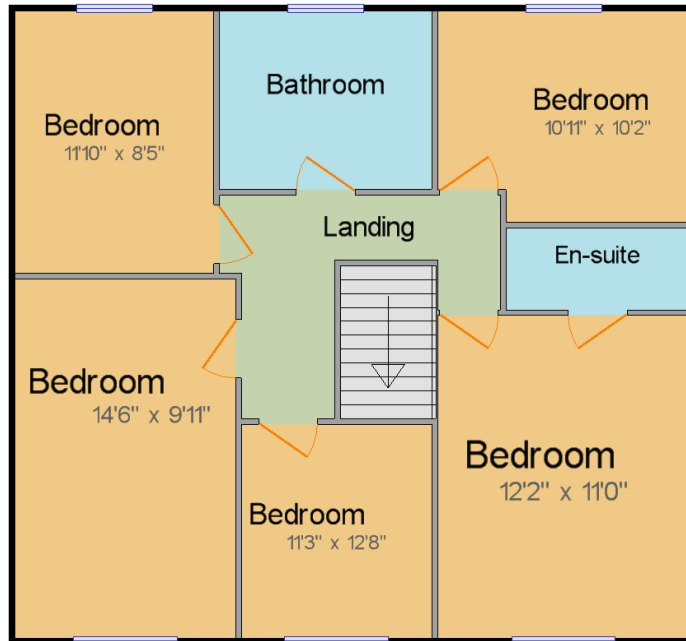

1st Floor

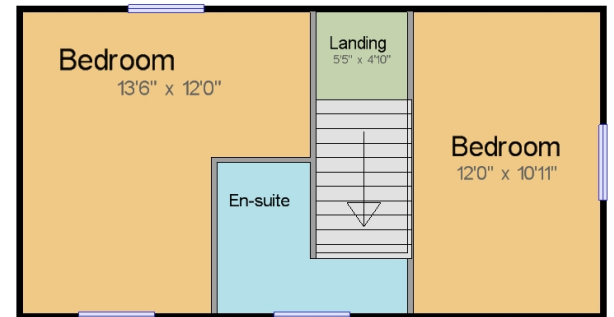

2nd Floor

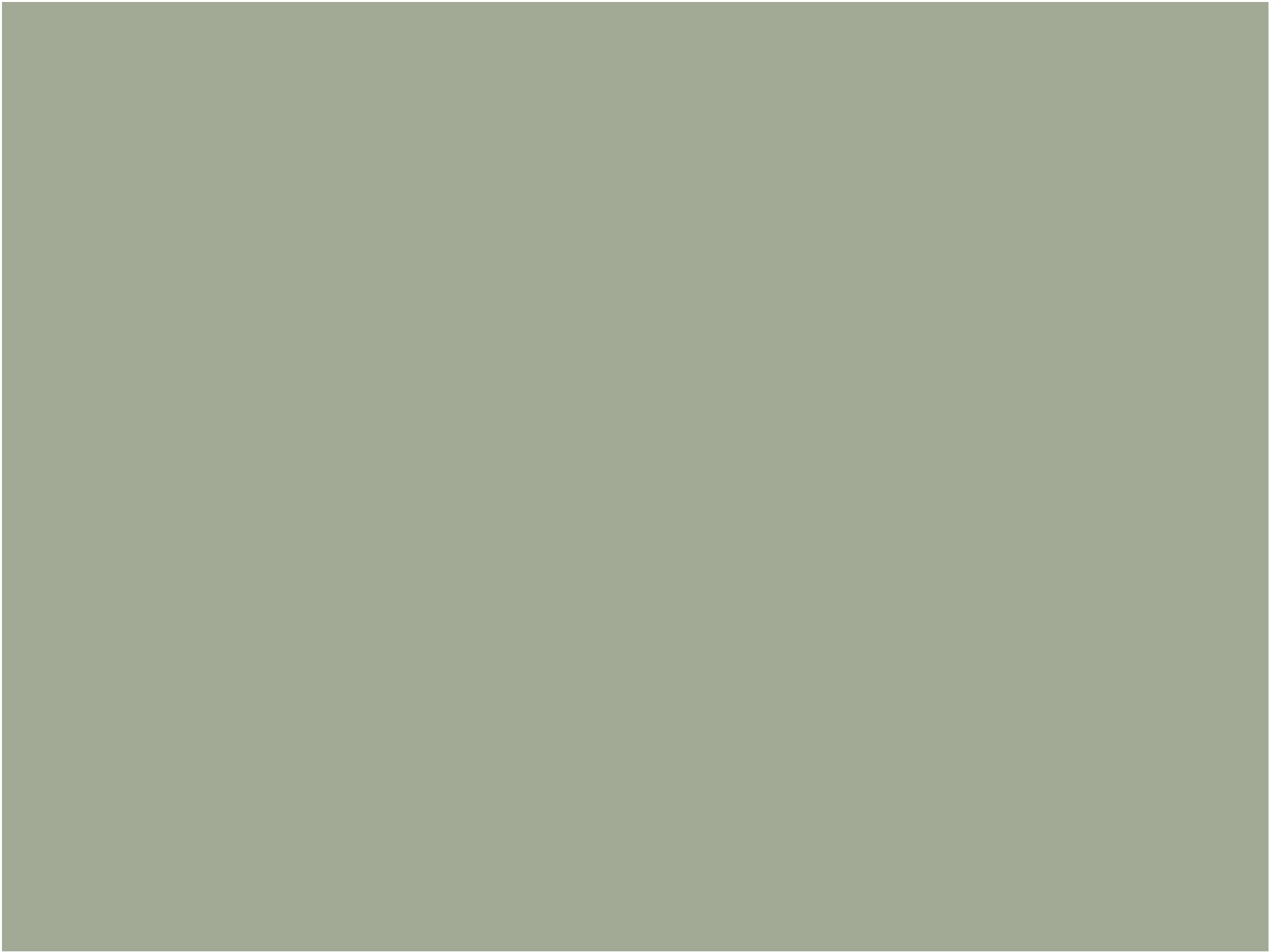

Visit <https://www.bairstoweves.co.uk>

Bairstoweves



Viewing arrangement by appointment

01277 652103

billericay@bairstowevescountrywide.co.uk Bairstow Eves, 125 High Street, Billericay



Land & New Homes | Auctions | Mortgage Services | Surveys | Conveyancing

Interested parties should satisfy themselves, by inspection or otherwise as to the accuracy of the description given and any floor plans shown in these property details. All measurements, distances and areas listed are approximate. Fixtures, fittings and other items are NOT included unless specified in these details.

Please note that any services, heating systems, or appliances have not been tested and no warranty can be given or implied as to their working order.

A member of Countrywide plc. Countrywide Estate Agents, trading as Bairstow Eves, registered office: Countrywide House, 88-103 Caldecotte Lake Drive, Caldecotte, Milton Keynes, MK7 8JT. Registered in England No. 789476 | Code Anglia EA_10335_BIL180263_SL6PLr

