

Winstree, Basildon, Essex
Asking Price **£115,000**

Bairstoweves

EPC **E**

1 Bedroom Flat For Sale.

This top floor flat comes to the market offering no onward chain and no stamp duty for a first time buyer it would also be ideal as an investment opportunity. The property boasts a generously sized lounge, modern fitted kitchen, 3-piece bathroom suite and good presentation throughout. The A127 and A13 transport links are easily accessible and local amenities are close by. Early viewing is advised, call today to arrange.

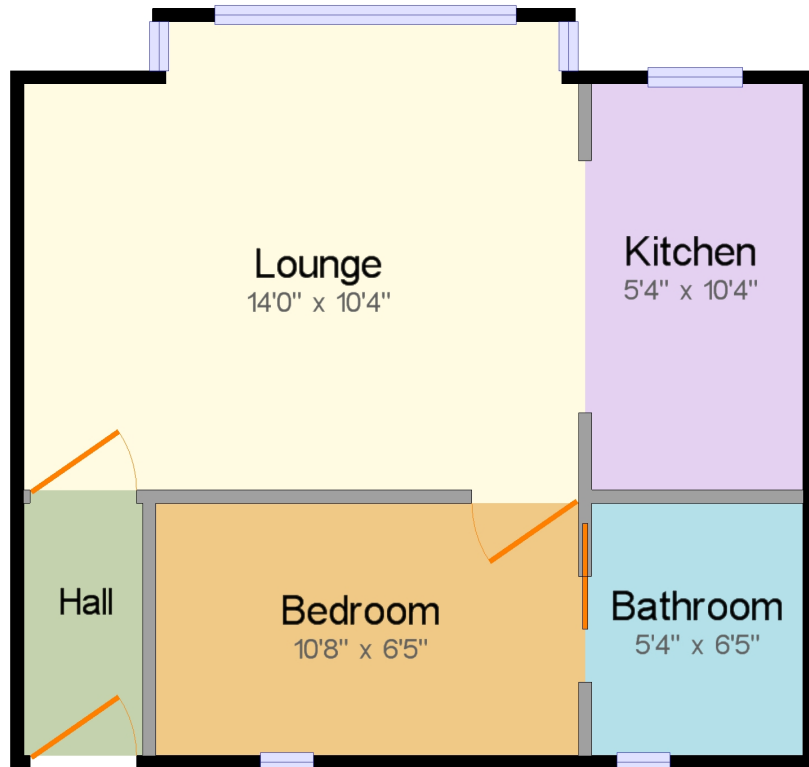

Ground Floor

Viewing arrangement by appointment.

01268 530939

fryerns@bairstowevescountrywide.co.uk Bairstow Eves, 106 Whitmore Way, Fryerns
Basildon



Countrywide Land & New Homes | Auctions | Mortgage Services | Surveys | Conveyancing

Interested parties should satisfy themselves, by inspection or otherwise as to the accuracy of the description given and any floor plans shown in these property details. All measurements, distances and areas listed are approximate. Fixtures, fittings and other items are NOT included unless specified in these details. **Please note that any services, heating systems, or appliances have not been tested and no warranty can be given as to their working order.**

A member of Countrywide plc. Countrywide Estate Agents, trading as Bairstow Eves, registered office: Countrywide House, 88-103 Caldecotte Lake Drive, Caldecotte, Milton Keynes, MK7 8JT. Registered in England No. 789476 | Code: Anglia EA_10344_FRY180057_SL2PPR

