

Premium



Easton Court, Smith Street London SW3

£700 Per Week - Available 15/06/2018



****SHORT LET** FULLY AVAILABLE** A lovely one bedroom apartment ideally located just off the King's Road, with all the shopping and travel amenities of the King's Road and Sloane Square. Available FROM JUNE 2018.

1 Bedroom | 1 Bathroom | Dishwasher | Fridge/Freezer | Microwave | Lift | SHORT LET.

Description

****SHORT LET** ALL BILLS INCLUDED** A lovely one bedroom apartment ideally located just off the King's Road, with all the shopping and travel amenities of the King's Road and Sloane Square. Set on the first floor with lift, offering a bright living room, separate kitchen, double bedroom and bathroom. Offered furnished. Available FROM JUNE 2018.

Situation

Easton Court is a well run building situated moments from the amenities of the King's Road and transport links at Sloane Square (Circle and District lines).

Furnishing

Furnished



Kitchen



Reception

Hamptons Sloane Square Lettings

7 Lower Sloane Street, Sloane Square

London SW1W 8AH

Tel: 020 7824 8242 - sloanesquarelettings@hamptons-int.com

www.hamptons.co.uk

FLAT G, EASTON COURT

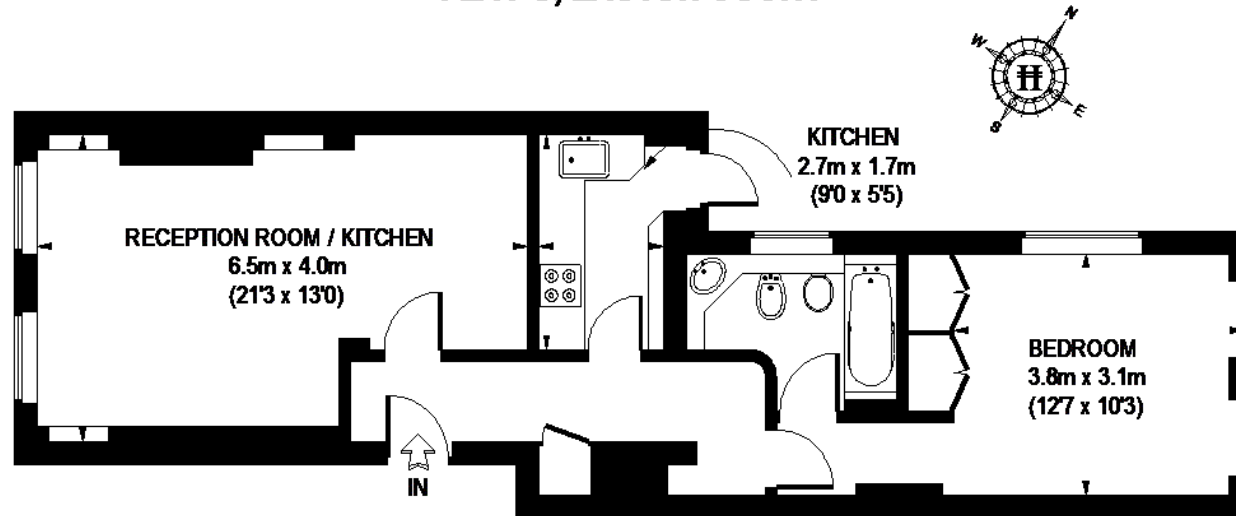

FIRST FLOOR

APPROXIMATE GROSS INTERNAL AREA = 635 SQ. FT. (59 SQ. M.)

This plan is for layout guidance only. Not drawn to scale unless stated. Windows & door openings are approximate. Whilst every care is taken in the preparation of this plan, please check all dimensions, shapes & compass bearings before making any decisions reliant upon them. Please be advised that Hamptons International / our agents have not seen or reviewed any building regulations or planning permission in relation to works carried out to the property. (ID29824)

For clarification, we wish to inform prospective purchasers that we have prepared these sales particulars as a general guide. We have not verified permissions, nor carried out a survey, tested the services, appliances and specific fittings. Room sizes are approximate and rounded: they are taken between internal wall surfaces and therefore include cupboards/shelves, etc. Accordingly, they should not be relied upon for carpets and furnishings. It should also be noted that all fixtures and fittings, carpeted, curtains/blinds, kitchen equipment and garden statuary, whether fitted or not, are deemed removable by the vendor unless specifically itemised with these particulars.

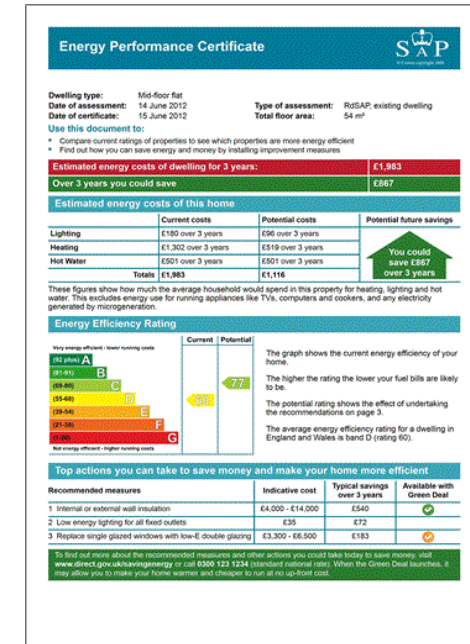

Hamptons Sloane Square Lettings

7 Lower Sloane Street, Sloane Square

London SW1W 8AH

Tel: 020 7824 8242 - sloanesquarelettings@hamptons-int.com

www.hamptons.co.uk

HAMPTONS
INTERNATIONAL