



The Mount Hampstead NW3

£2,000 Per Week - Available 02/01/2018

HAMPTONS
INTERNATIONAL

Beyond your expectations

The Mount Hampstead NW3

£2,000 Per Week - Available 02/01/2018

HAMPTONS
INTERNATIONAL

SHORT LET. A beautifully refurbished and impeccably styled two bedroom apartment to let. Located in the heart of Hampstead Village and within walking distance of both Hampstead tube and other local amenities.

Beautifully refurbished | Modern kitchen | Open plan | Two bedrooms | Two bathrooms | Furnished or unfurnished.

Description

SHORT LET. A beautifully refurbished and impeccably styled two bedroom apartment to let. Located in the heart of Hampstead Village and within walking distance of both Hampstead tube and the local amenities of Hampstead Village. Comprising a spacious open plan kitchen and reception, master bedroom with en suite and fitted wardrobes, a second bedroom and a second family bathroom. Finished with neutral décor and a mix of wood floors and neutral carpets throughout. Offered furnished or unfurnished and available now.

Furnishing

Furnished



Reception



Kitchen

Hamptons Hampstead Lettings

21 Heath Street, Hampstead

London NW3 6TR

Tel: 020 7431 4462 - HampsteadLettings@hamptons-int.com

www.hamptons.co.uk

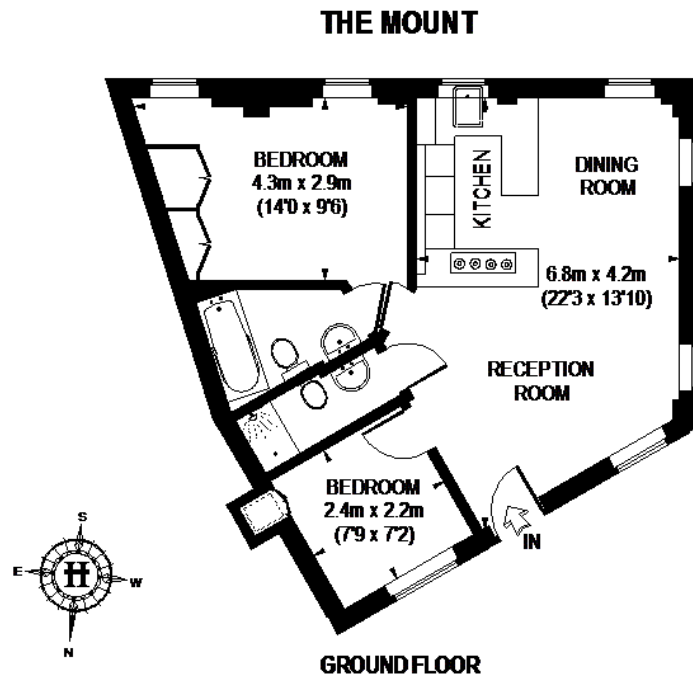

= REDUCED HEADROOM BELOW 1.5 M / 5'0
APPROXIMATE GROSS INTERNAL AREA
(EXCLUDING REDUCED HEADROOM) = 549 SQ. FT. (51 SQ. M.)
REDUCED HEADROOM = 2 SQ. FT. (0.2 SQ. M.)
TOTAL = 551 SQ. FT. (51.2 SQ. M.)

This plan is for layout guidance only. Not drawn to scale unless stated. Windows & door openings are approximate. Whilst every care is taken in the preparation of this plan, please check all dimensions, shapes & compass bearings before making any decisions reliant upon them. Please be advised that Hamptons International / our agents have not seen or reviewed any building regulations or planning permission in relation to works carried out to the property. (ID73136)

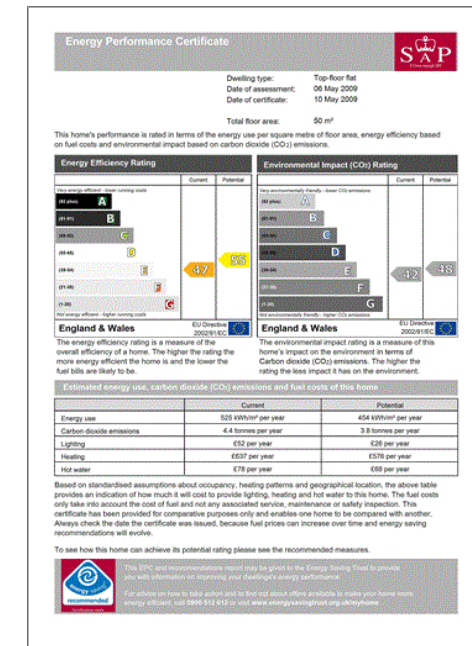

For clarification, we wish to inform prospective purchasers that we have prepared these sales particulars as a general guide. We have not verified permissions, nor carried out a survey, tested the services, appliances and specific fittings. Room sizes are approximate and rounded: they are taken between internal wall surfaces and therefore include cupboards/shelves, etc. Accordingly, they should not be relied upon for carpets and furnishings. It should also be noted that all fixtures and fittings, carpeted, curtains/blinds, kitchen equipment and garden statuary, whether fitted or not, are deemed removable by the vendor unless specifically itemised with these particulars.

Hamptons Hampstead Lettings

21 Heath Street, Hampstead

London NW3 6TR

Tel: 020 7431 4462 - HampsteadLettings@hamptons-int.com

www.hamptons.co.uk

HAMPTONS
INTERNATIONAL

Beyond your expectations