



Bracknell Gardens Hampstead NW3

£1,350 Per Week - Available 18/09/2017

**HAMPTONS**  
INTERNATIONAL

*Beyond your expectations*



# Bracknell Gardens Hampstead NW3

£1,350 Per Week - Available 18/09/2017

**HAMPTONS**  
INTERNATIONAL

*A stunning four bedroom triplex penthouse apartment to let. Situated in a gated conversion close to Hampstead tube as well as the local amenities of Hampstead Village and the open spaces of Hampstead Heath.*

4 bedroom penthouse | Spacious double reception | 4 bedrooms | 3 bathrooms | Off street parking |  
Pets considered.

## Description

A stunning four bedroom triplex penthouse apartment to let. Situated in a gated conversion close to Hampstead tube as well as the local amenities of Hampstead Village and the open spaces of Hampstead Heath. The property comprises a spacious double reception room with vaulted ceiling height and a spiral staircase leading upstairs to a study with amazing views, a fully fitted kitchen diner, master bedroom with ensuite, two further double bedrooms with fitted wardrobes, a fourth bedroom/dressing room and an additional family bathroom. Finished with neutral décor and a mix of neutral carpets and hard wood flooring throughout. Benefits of the building include a caretaker/porter, lift and off street parking. Offered part furnished or unfurnished and available from mid September

2017.

## Furnishing

Part-furnished



Reception



Reception

## Hamptons Hampstead Lettings

21 Heath Street, Hampstead

London NW3 6TR

Tel: 020 7431 4462 - [HampsteadLettings@hamptons-int.com](mailto:HampsteadLettings@hamptons-int.com)

[www.hamptons.co.uk](http://www.hamptons.co.uk)

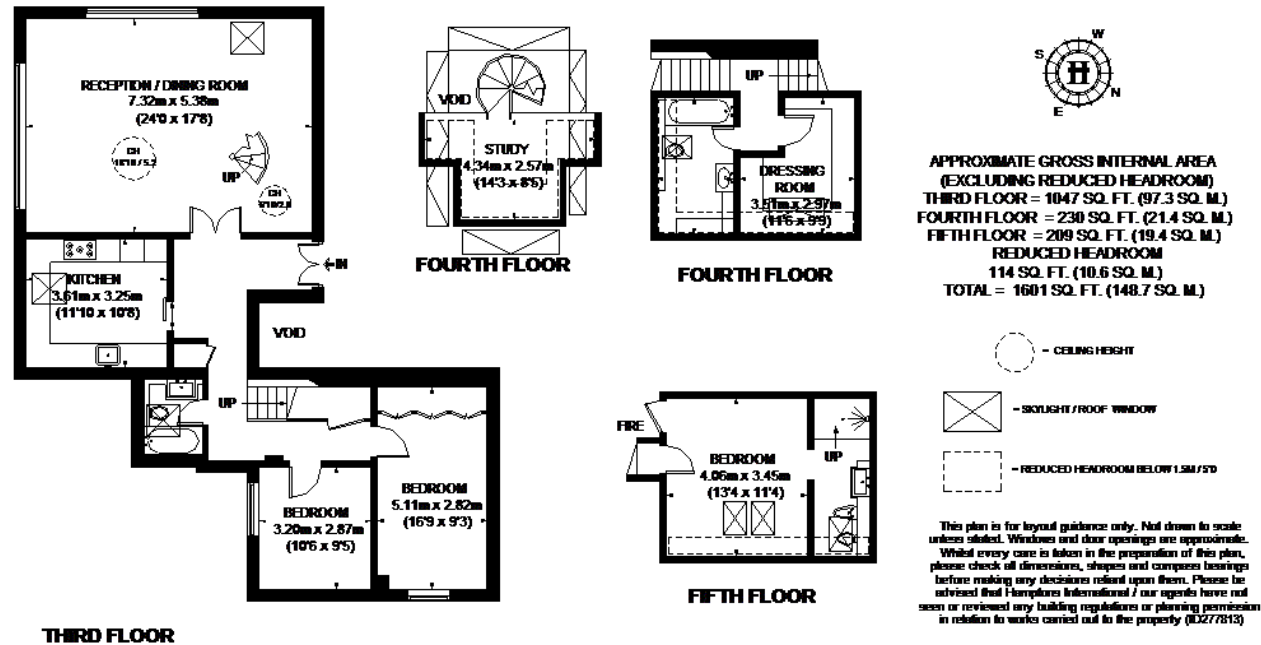

**For clarification,** we wish to inform prospective purchasers that we have prepared these sales particulars as a general guide. We have not verified permissions, nor carried out a survey, tested the services, appliances and specific fittings. Room sizes are approximate and rounded: they are taken between internal wall surfaces and therefore include cupboards/shelves, etc. Accordingly, they should not be relied upon for carpets and furnishings. It should also be noted that all fixtures and fittings, carpeted, curtains/blinds, kitchen equipment and garden statuary, whether fitted or not, are deemed removable by the vendor unless specifically itemised with these particulars.