



Parkview Court, SW6, EPC C

£750 Per Week - Available Now

**HAMPTONS**  
INTERNATIONAL

*Beyond your expectations*

*A stunning three bedroom penthouse apartment in a well maintained Portered building offering fabulous views.*

3 Bedrooms | 2 Bathrooms | Dishwasher | Fridge/Freezer | Oven | Washer\Dryer | Porter | Balcony.

### Description

A stunning three bedroom penthouse well located for Putney Bridge tube station with amazing views. The property is in a portered building. The flat is finished to the highest of standards with beautiful wooden floors throughout and underfloor heating. There are three double bedrooms, two bathrooms and an open plan kitchen reception with a west facing balcony.

### Furnishing

Unfurnished



114-Parkview-Court-002



114-Parkview-Court-004

### Hamptons Fulham Lettings

193 New Kings Road, Fulham

London SW6 4SS

Tel: 020 7371 0299 - [fulhamlettings@hamptons-int.com](mailto:fulhamlettings@hamptons-int.com)

[www.hamptons.co.uk](http://www.hamptons.co.uk)

## Floorplan

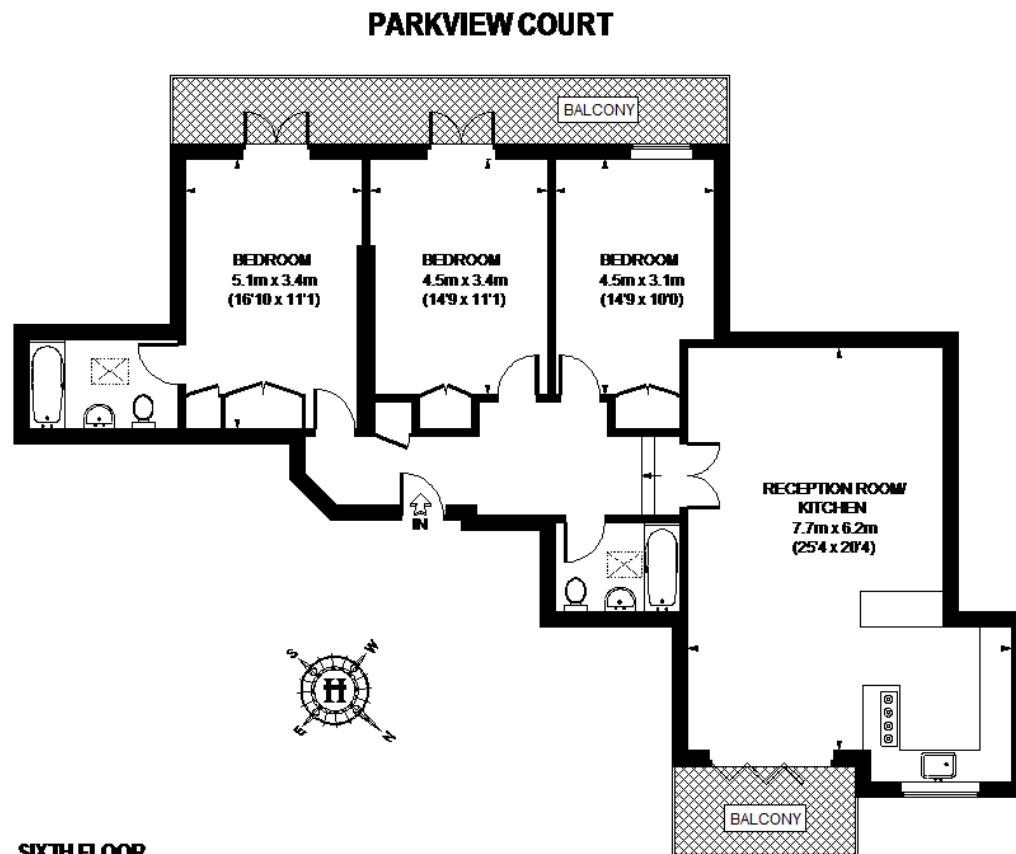

APPROXIMATE GROSS INTERNAL AREA = 1249 SQ. FT. (116 SQ. M.)

This plan is for layout guidance only. Not drawn to scale unless stated. Windows & door openings are approximate. Whilst every care is taken in the preparation of this plan, please check all dimensions, shapes & compass bearings before making any decisions relied upon them.

**For clarification,** we wish to inform prospective purchasers that we have prepared these sales particulars as a general guide. We have not verified permissions, nor carried out a survey, tested the services, appliances and specific fittings. Room sizes are approximate and rounded: they are taken between internal wall surfaces and therefore include cupboards/shelves, etc. Accordingly, they should not be relied upon for carpets and furnishings. It should also be noted that all fixtures and fittings, carpeted, curtains/blinds, kitchen equipment and garden statuary, whether fitted or not, are deemed removable by the vendor unless specifically itemised with these particulars.

## Energy Performance Certificate (EPC)

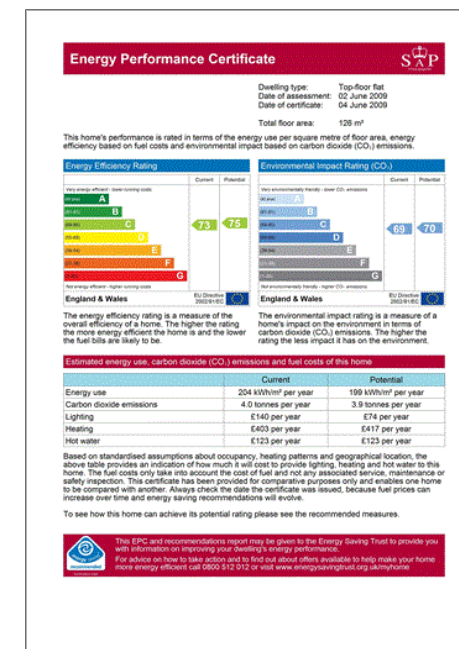

## Hamptons Fulham Lettings

193 New Kings Road, Fulham

London SW6 4SS

Tel: 020 7371 0299 - [fulhamlettings@hamptons-int.com](mailto:fulhamlettings@hamptons-int.com)

[www.hamptons.co.uk](http://www.hamptons.co.uk)

**HAMPTONS**  
INTERNATIONAL

Beyond your expectations