



Townmead Road London SW6, EPC C

£323 Per Week - Available Now

**HAMPTONS**  
INTERNATIONAL

*Beyond your expectations*

# Townmead Road London SW6, EPC C

£323 Per Week - Available Now

**HAMPTONS**  
INTERNATIONAL

*50% OFF FIRST MONTH'S RENT; A brand new smart studio apartment located on the 7th floor (with lift) of this highly prestigious development with fantastic views accross London.*

Studio Apartment | 24 hour porter | Great views from the 7th floor | Brand new kitchen | Brand new bathroom.

## Description

50% OFF FIRST MONTH'S RENT A brand new smart studio apartment located on the 7th floor (with lift) of this highly prestigious development with fantastic views accross London. The property comprises spacious and bright studio space with wooden floors, fully fitted kitchen and a modern shower room.

## Situation

Situated closed to local amenities and Imperial Wharf station is moments away.

## Furnishing

Furnished



Bathroom



External

## Hamptons Fulham Lettings

193 New Kings Road, Fulham

London SW6 4SS

Tel: 020 7371 0299 - [fulhamlettings@hamptons-int.com](mailto:fulhamlettings@hamptons-int.com)

[www.hamptons.co.uk](http://www.hamptons.co.uk)

## OCTAVIA HOUSE

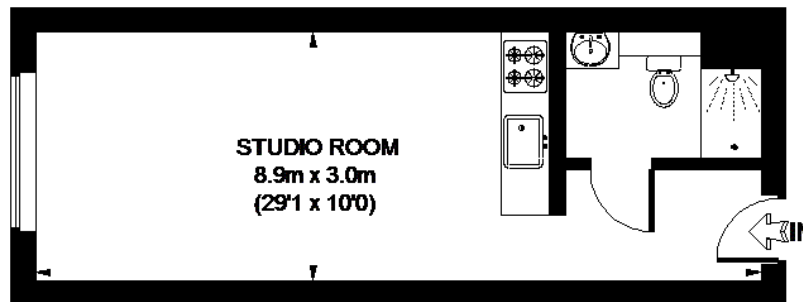
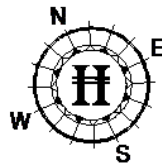

## SEVENTH FLOOR

APPROXIMATE GROSS INTERNAL AREA  
291 SQ. FT. (27 SQ. M.)

This plan is for layout guidance only. Not drawn to scale unless stated. Windows & door openings are approximate. Whilst every care is taken in the preparation of this plan, please check all dimensions, shapes & compass bearings before making any decisions reliant upon them. Please be advised that Hamptons International / our agents have not seen or reviewed any building regulations or planning permission in relation to works carried out to the property. (ID110666)

**For clarification,** we wish to inform prospective purchasers that we have prepared these sales particulars as a general guide. We have not verified permissions, nor carried out a survey, tested the services, appliances and specific fittings. Room sizes are approximate and rounded: they are taken between internal wall surfaces and therefore include cupboards/shelves, etc. Accordingly, they should not be relied upon for carpets and furnishings. It should also be noted that all fixtures and fittings, carpeted, curtains/blinds, kitchen equipment and garden statuary, whether fitted or not, are deemed removable by the vendor unless specifically itemised with these particulars.

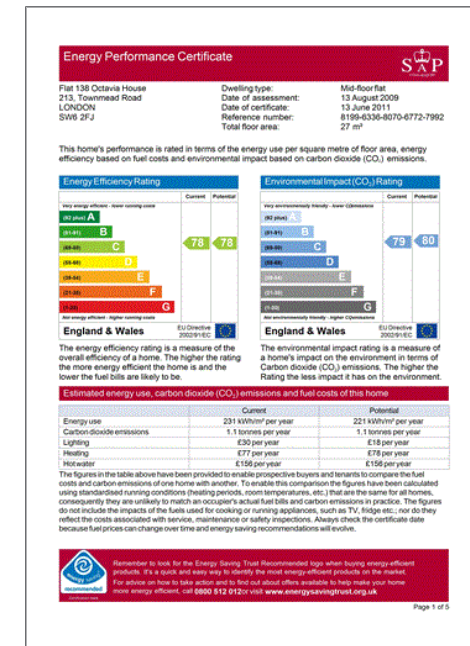

## Hamptons Fulham Lettings

193 New Kings Road, Fulham

London SW6 4SS

Tel: 020 7371 0299 - [fulhamlettings@hamptons-int.com](mailto:fulhamlettings@hamptons-int.com)

[www.hamptons.co.uk](http://www.hamptons.co.uk)

**HAMPTONS**  
INTERNATIONAL

Beyond your expectations