



Cornwall Gardens South Kensington SW7

£1,600 Per Week - Available Now

**HAMPTONS**  
INTERNATIONAL

*Beyond your expectations*

# Cornwall Gardens South Kensington SW7

£1,600 Per Week - Available Now

**HAMPTONS**  
INTERNATIONAL

*Presented in immaculate order, this beautifully refurbished two bedroom apartment is situated on the third floor of this stucco fronted period building. Benefiting from high tech appliances and oak wood floors throughout.*

2 Bedrooms | 2 Bathrooms | CCTV & Security | Integrated Media System | Lift | Communal Garden | Permit Parking.

## Description

Presented in immaculate order, this beautifully refurbished two bedroom apartment is situated on the third floor of this beautiful stucco fronted period building. The apartment comprises bright reception room, two bedrooms and two bathrooms (one en suite). There is lift access to the 2nd floor and amazing garden views. The apartment has designer Italian furniture, silk blinds, all the latest AV equipment, Airplay in every room and Apple TV with Sky. It is served by two dedicated maids, a Yoga & Pilates Studio, with out own personal trainer.

## Situation

Cornwall Gardens is located close the shop, restaurants and transport links (Piccadilly and District lines) of Gloucester Road. Kensington

High Street and Hyde Park are also close by.

## Furnishing

Furnished



Kitchen



External

## Hamptons Kensington Lettings

8 Hornton Street, Kensington

London W8 4NW

Tel: 020 7937 9372 - [KensingtonLettings@hamptons-int.com](mailto:KensingtonLettings@hamptons-int.com)

[www.hamptons.co.uk](http://www.hamptons.co.uk)

## Floorplan

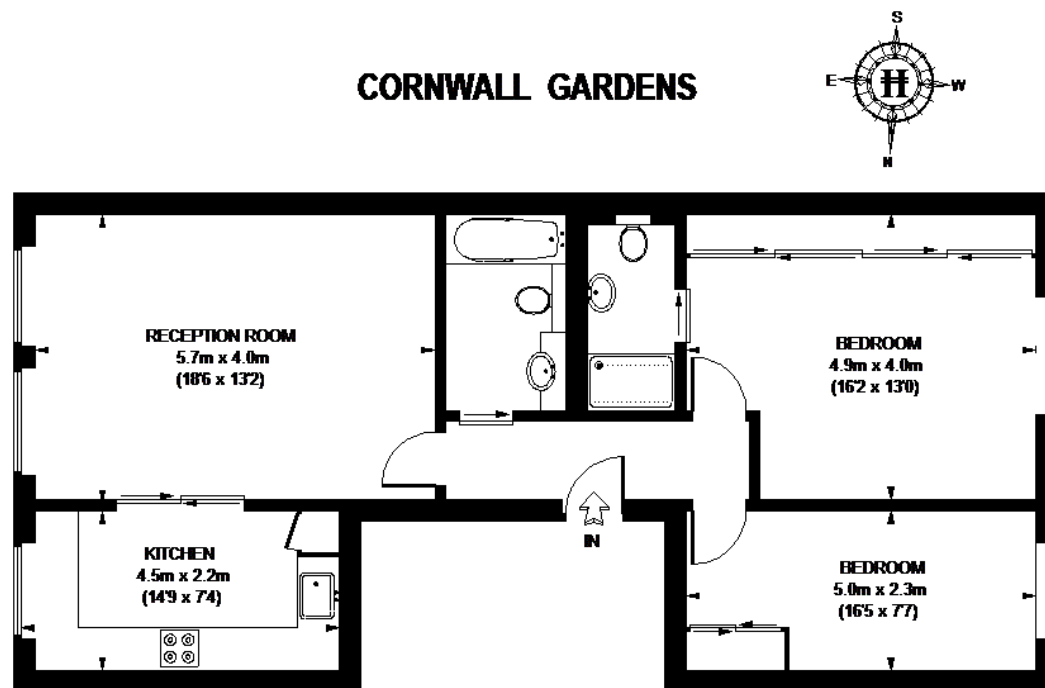

APPROXIMATE GROSS INTERNAL AREA  
861 SQ. FT. (80 SQ. M.)

This plan is for layout guidance only. Not drawn to scale unless stated. Windows & door openings are approximate. Whilst every care is taken in the preparation of this plan, please check all dimensions, shapes & compass bearings before making any decisions reliant upon them. Please be advised that Hamptons International / our agents have not seen or reviewed any building regulations or planning permission in relation to works carried out to the property. (ID90295)

## Energy Performance Certificate (EPC)

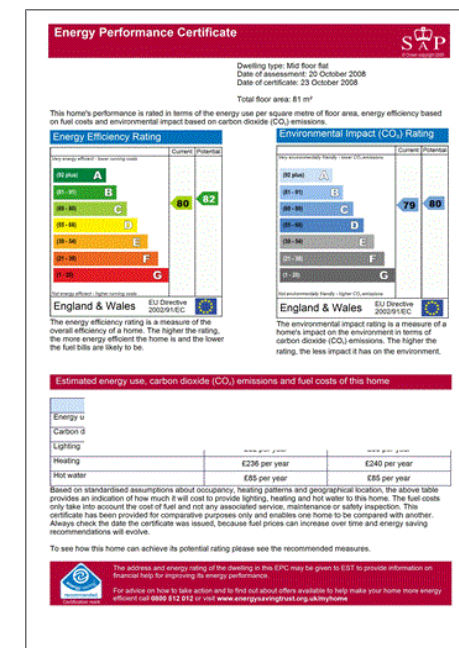

**For clarification**, we wish to inform prospective purchasers that we have prepared these sales particulars as a general guide. We have not verified permissions, nor carried out a survey, tested the services, appliances and specific fittings. Room sizes are approximate and rounded: they are taken between internal wall surfaces and therefore include cupboards/shelves, etc. Accordingly, they should not be relied upon for carpets and furnishings. It should also be noted that all fixtures and fittings, carpeted, curtains/blinds, kitchen equipment and garden statuary, whether fitted or not, are deemed removable by the vendor unless specifically itemised with these particulars.

## Hamptons Kensington Lettings

8 Hornton Street, Kensington

London W8 4NW

Tel: 020 7937 9372 - [KensingtonLettings@hamptons-int.com](mailto:KensingtonLettings@hamptons-int.com)

[www.hamptons.co.uk](http://www.hamptons.co.uk)

**HAMPTONS**  
INTERNATIONAL

*Beyond your expectations*