



Palgrave Gardens St Johns Wood NW1

£850 Per Week - Available Now

HAMPTONS
INTERNATIONAL

Beyond your expectations

Palgrave Gardens St Johns Wood NW1

£850 Per Week - Available Now

HAMPTONS
INTERNATIONAL

A modern three bedroom apartment with bright open plan reception room on the third floor of this sought-after development.

On Site Gym | Porter | Indoor Swimming Pool | Parking Available | Council Tax Band G - £1147 pa.

Description

A modern three bedroom apartment on the third floor of this sought-after development. There is a spacious open plan reception room with direct access to a terrace. The master bedroom has fitted wardrobes, en suite bathroom and direct access to a terrace. There is a second double bedroom with fitted storage, a further third bedroom and a family bathroom. Use of the gym and pool facilities in Palgrave Gardens are included.

Situation

St John's Wood is a district of northwest London, in the City of Westminster, and on the northwest side of Regent's Park. It is about 2.5 miles (4 km) northwest of Charing Cross. Once part of the Great Middlesex Forest, it was later

owned by the Knights of St John of Jerusalem. The boundaries of St. John's Wood are the Regent's Canal to the south, Maida Vale (Edgware Road) to the west, Boundary Road to the north and Avenue Rd/Primrose Hill Park to the east. St John's Wood is the location of Lord's Cricket Ground, home of Middlesex County Cricket Club and of the Marylebone Cricket Club (MCC), and the original headquarters of cricket. It is also famous for Abbey Road Studios and the street Abbey Road, where The Beatles recorded

Furnishing

Furnished



Hamptons St Johns Wood Lettings

99 St Johns Wood Terrace, St Johns Wood

London NW8 6PL

Tel: 020 7722 2131 - stjohnswoodlettings@hamptons-int.com

www.hamptons.co.uk

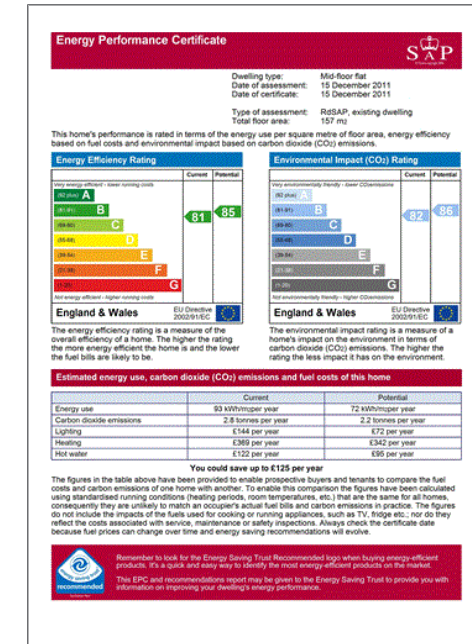
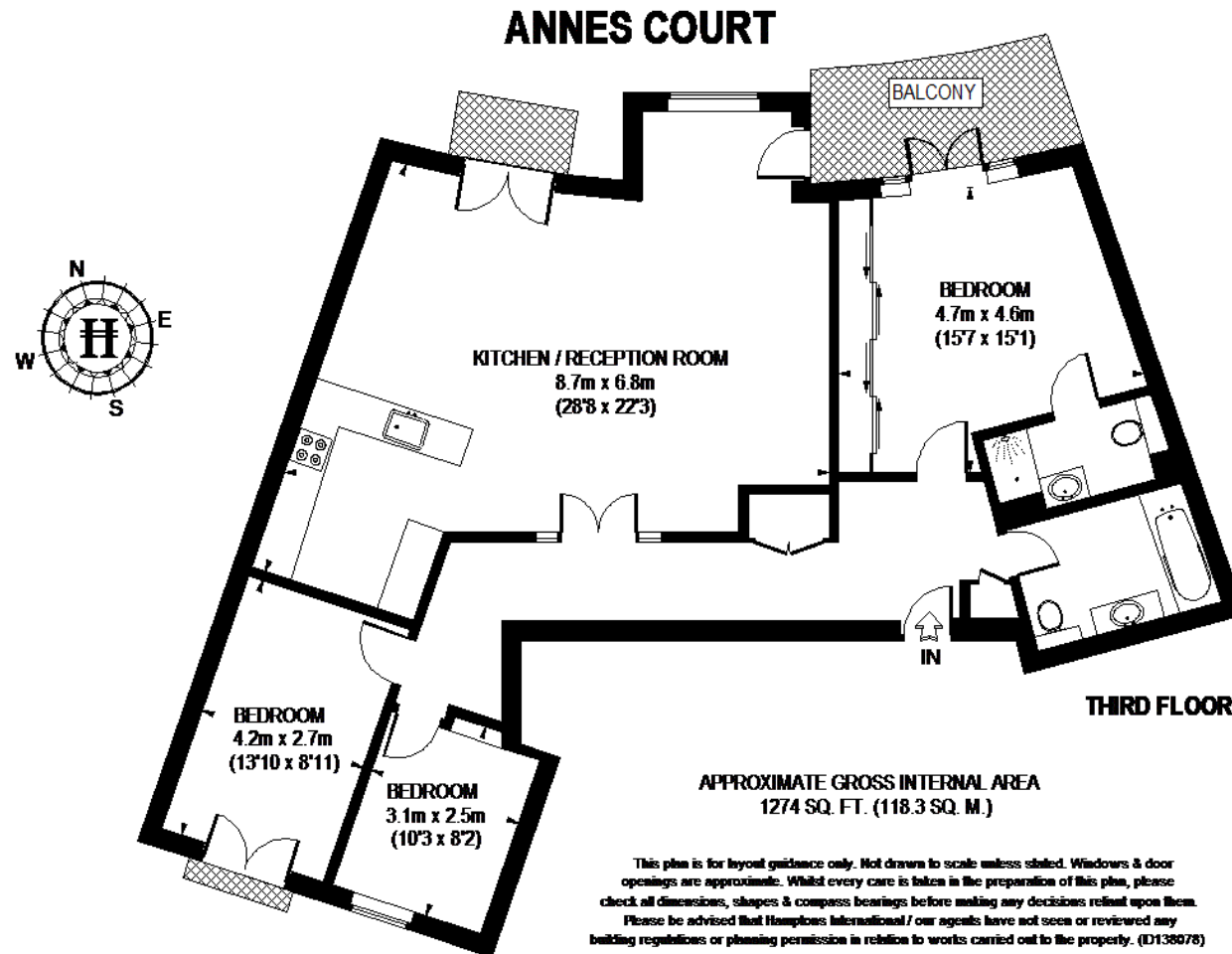

For clarification, we wish to inform prospective purchasers that we have prepared these sales particulars as a general guide. We have not verified permissions, nor carried out a survey, tested the services, appliances and specific fittings. Room sizes are approximate and rounded: they are taken between internal wall surfaces and therefore include cupboards/shelves, etc. Accordingly, they should not be relied upon for carpets and furnishings. It should also be noted that all fixtures and fittings, carpeted, curtains/blinds, kitchen equipment and garden statuary, whether fitted or not, are deemed removable by the vendor unless specifically itemised with these particulars.

Hamptons St Johns Wood Lettings

99 St Johns Wood Terrace, St Johns Wood

London NW8 6PL

Tel: 020 7722 2131 - stjohnswoodlettings@hamptons-int.com

www.hamptons.co.uk

HAMPTONS
INTERNATIONAL

Beyond your expectations