



Park Street London SE1

£470 Per Week - Available Now

HAMPTONS
INTERNATIONAL

Beyond your expectations

A spacious one bedroom apartment in this popular location, moments from the South Bank and the famous Borough Market. The property benefits from a second mezzanine area, ideal as a reception room.

Gated Development | Superb Location | Mezzanine Office/Bedroom | Excellent Transport Links | One Bedroom | Close to Borough Market.

Description

A spacious one bedroom apartment in this popular location, moments from the South Bank and the famous Borough Market. The property benefits from a second mezzanine area, ideal as a reception room.

main line station and tube (Jubilee & Northern Lines), Waterloo mainline station and tube or Southwark tube (Jubilee line) and the Clipper services at Bankside & London Bridge.

Furnishing

Furnished

Situation

The area of Bankside is a hive of activity with many attractions on the doorstep including the renowned and award winning Borough Market, London's oldest food market which attracts both locals and tourists. Further highlights of the area are The Tate Modern and the magnificent Southwark Cathedral. For those not walking over a bridge into the City, transport options include Blackfriars Station (new entrance and ticket hall on the south side of the river), London Bridge



Reception



Dining

Hamptons Tower Bridge Lettings

41 Shad Thames, Tower Bridge

London SE1 2NJ

Tel: 020 7407 3172 - towerbridgelettings@hamptons-int.com

www.hamptons.co.uk

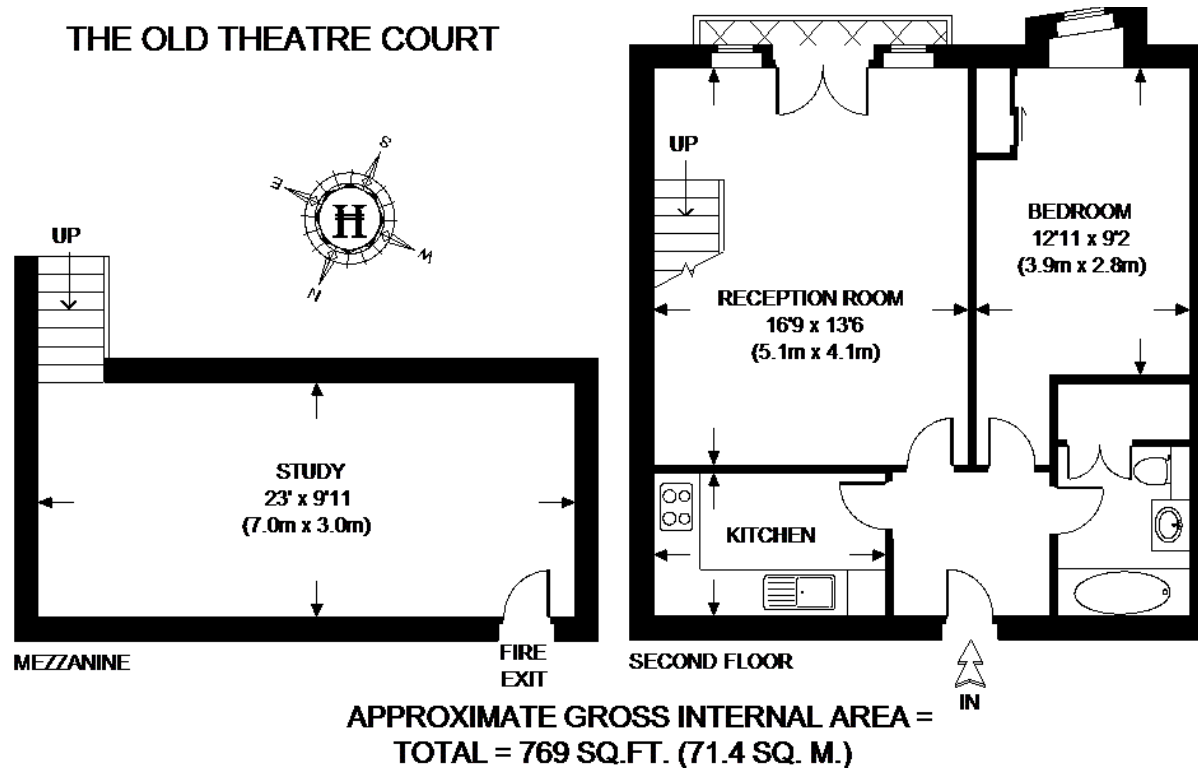

This plan is for layout guidance only. Not drawn to scale unless stated. Windows & door openings are approximate. Whilst every care is taken in the preparation of this plan, please check all dimensions, shapes & compass bearings before making any decisions reliant upon them. Please be advised that Hamptons International / our agents have not seen or reviewed any building regulations or planning permission in relation to works carried out to the property.

For clarification, we wish to inform prospective purchasers that we have prepared these sales particulars as a general guide. We have not verified permissions, nor carried out a survey, tested the services, appliances and specific fittings. Room sizes are approximate and rounded: they are taken between internal wall surfaces and therefore include cupboards/shelves, etc. Accordingly, they should not be relied upon for carpets and furnishings. It should also be noted that all fixtures and fittings, carpeted, curtains/blinds, kitchen equipment and garden statuary, whether fitted or not, are deemed removable by the vendor unless specifically itemised with these particulars.

