



British Grove South Chiswick W4

£350 Per Week - Available Now

HAMPTONS
INTERNATIONAL

Beyond your expectations

British Grove South Chiswick W4

£350 Per Week - Available Now

HAMPTONS
INTERNATIONAL

A charming two double bedroom furnished duplex maisonette comprising two bathrooms, bright reception room and fitted kitchen ideally located for the River Thames.

Two Double Bedrooms | Two Bathrooms | Maisonette | Furnished | Communal Gardens | Close To The River | Duplex.

Description

A charming two double bedroom furnished duplex maisonette comprising two bathrooms, bright reception room and fitted kitchen ideally located for the River Thames.

Furnishing

Furnished



Hamptons Chiswick Lettings

48 Turnham Green Terrace, Chiswick

London W4 1QP

Tel: 0208 987 8443 - chiswicklettings@hamptons-int.com

www.hamptons.co.uk

Floorplan

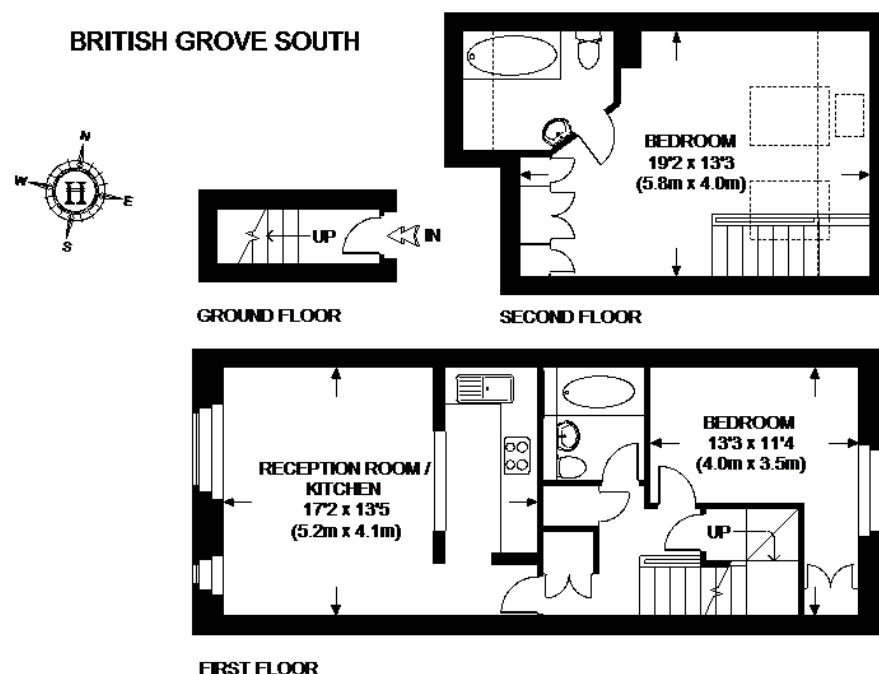

APPROXIMATE GROSS INTERNAL AREA =
TOTAL = 716 SQ. FT. (66.5 SQ. M.)

REDUCED HEIGHT AREA = 48 SQ.FT. (4.5 SQ. M.)

This plan is for layout guidance only. Not drawn to scale unless stated. Windows & door openings are approximate. Whilst every care is taken in the preparation of this plan, please check all dimensions, shapes & compass bearings before making any decisions reliant upon them. Please be advised that Hamptons International / our agents have not seen or reviewed any building regulations or planning permission in relation to works carried out to the property.

Energy Performance Certificate (EPC)

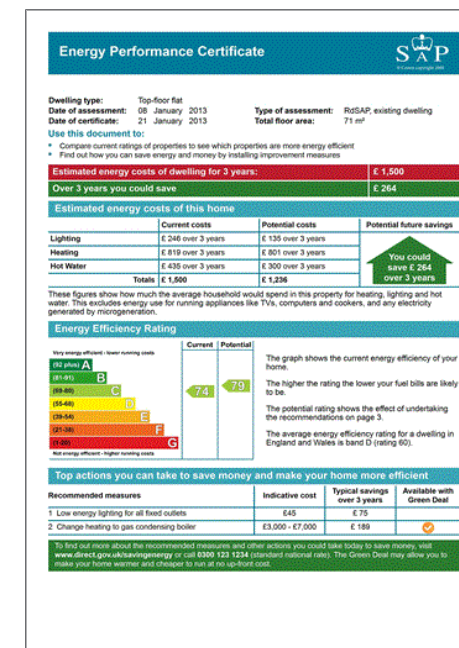

For clarification, we wish to inform prospective purchasers that we have prepared these sales particulars as a general guide. We have not verified permissions, nor carried out a survey, tested the services, appliances and specific fittings. Room sizes are approximate and rounded: they are taken between internal wall surfaces and therefore include cupboards/shelves, etc. Accordingly, they should not be relied upon for carpets and furnishings. It should also be noted that all fixtures and fittings, carpeted, curtains/blinds, kitchen equipment and garden statuary, whether fitted or not, are deemed removable by the vendor unless specifically itemised with these particulars.

Hamptons Chiswick Lettings

48 Turnham Green Terrace, Chiswick
 London W4 1QP

Tel: 0208 987 8443 - chiswicklettings@hamptons-int.com

www.hamptons.co.uk

HAMPTONS
 INTERNATIONAL

Beyond your expectations