



Kings Road Windsor SL4

£1,995 Per Month - Available Now

**HAMPTONS**  
INTERNATIONAL

*Beyond your expectations*



*A superb four storey town house with recently re furbished kitchen and bathrooms, set in this gated development and located in the heart of the town centre with far reaching balcony views of Windsor Castle & the Long Walk. Available for both Long Let and Short Let. Council Tax band G*

### Description

A superb four storey town house set in this gated development and located in the heart of the town centre with far reaching balcony views of Windsor Castle & the Long Walk. Kings Road is an exclusive address in the heart of the town centre adjacent to the stunning Long Walk of Windsor Castle which leads to The Copper Horse. The property has 4 bedrooms, 2 reception rooms and 2 bathrooms, the garage is to the rear approached via a gated entrance. Ideally situated within the Golden Triangle for easy reach of the town centre which offers an excellent range of shops, bars and restaurants. For the commuter there are two train stations serving London Paddington (via Slough) and London Waterloo (mainline approx 50 mins).

### Situation

Ideally situated within the Golden Triangle for easy reach of the town centre which offers an excellent range of shops, bars and restaurants. For the commuter there are two train stations serving London Paddington (via Slough) and London Waterloo (mainline approx 50 mins).

### Furnishing

Unfurnished



### Hamptons Windsor Lettings

52 High Street

Windsor SL4 1LS

Tel: 01753 867800 - windsorlettings@hamptons-int.com

[www.hamptons.co.uk](http://www.hamptons.co.uk)

Kings Road, Windsor

Approximate Gross Internal Area = 133.5 sq m / 1437 sq ft  
(Excluding Eaves)



 = Reduced headroom below 1.5m / 5'0"

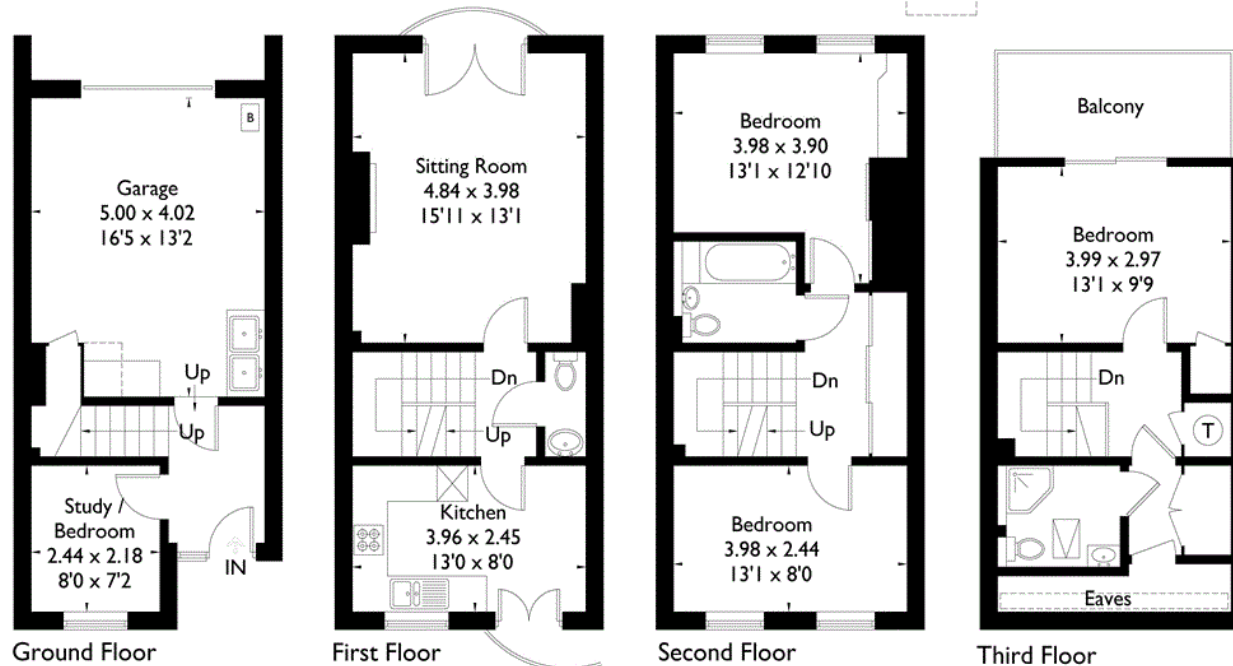

FLOORPLANZ © 2016 0845 6344080 Ref: 170236

This plan is for layout guidance only. Drawn in accordance with RICS guidelines. Not drawn to scale unless stated. Windows & door openings are approximate. Whilst every care is taken in the preparation of this plan, please check all dimensions, shapes & compass bearings before making any decisions reliant upon them.

**For clarification,** we wish to inform prospective purchasers that we have prepared these sales particulars as a general guide. We have not verified permissions, nor carried out a survey, tested the services, appliances and specific fittings. Room sizes are approximate and rounded: they are taken between internal wall surfaces and therefore include cupboards/shelves, etc. Accordingly, they should not be relied upon for carpets and furnishings. It should also be noted that all fixtures and fittings, carpeted, curtains/blinds, kitchen equipment and garden statuary, whether fitted or not, are deemed removable by the vendor unless specifically itemised with these particulars.

