



Folgate Street London E1

£715 Per Week - Available Now

HAMPTONS
INTERNATIONAL

Beyond your expectations

Beautifully refurbished two bedroom apartment located in the heart of Spitalfields conservation area, benefiting from newly installed high specification bathrooms, Bulthaup kitchen and lighting, wood flooring throughout and a stylish furniture pack. This second floor property also enjoys a south facing balcony with views of residents gardens towards Spitalfields market.

Description

Beautifully refurbished two bedroom apartment located in the heart of Spitalfields conservation area, benefiting from newly installed high specification bathrooms, Bulthaup kitchen and lighting, wood flooring throughout and a stylish furniture pack. This second floor property also enjoys a south facing balcony with views of residents gardens towards Spitalfields market. The development comes with 24 hour concierge. Folgate Street is a cobblestone cul-de-sac, with tall 18th century town houses and lampposts superbly located in the heart of Spitalfields, moments from the bars, restaurants and nightlife of vibrant Shoreditch, Spitalfields Market and Brick Lane. The City of London is also close by. Transport links are excellent with Liverpool Street, Aldgate East and Shoreditch stations

nearby. Underground parking is available by separate negotiation.

Furnishing

Furnished



Hamptons City Lettings

Aldermay House 15 Queen Street

London EC4N 1TX

Tel: 020 7236 8399 - citylettings@hamptons-int.com

www.hamptons.co.uk

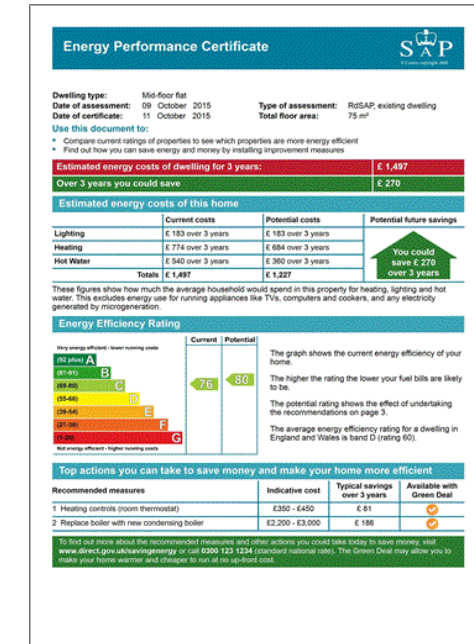
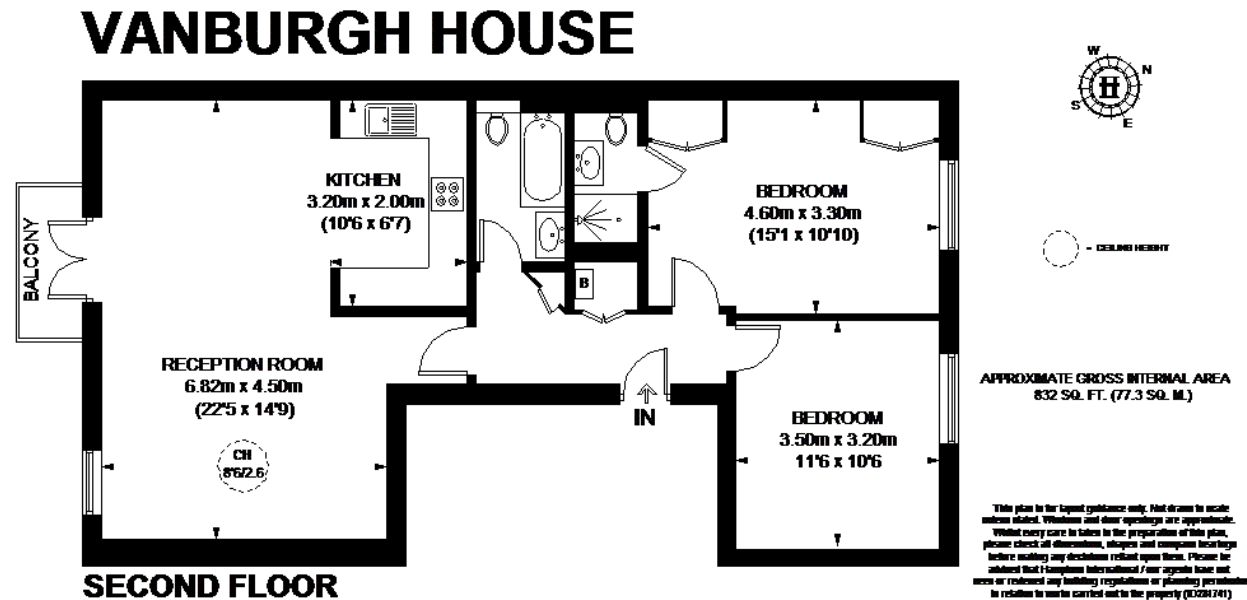

For clarification, we wish to inform prospective purchasers that we have prepared these sales particulars as a general guide. We have not verified permissions, nor carried out a survey, tested the services, appliances and specific fittings. Room sizes are approximate and rounded: they are taken between internal wall surfaces and therefore include cupboards/shelves, etc. Accordingly, they should not be relied upon for carpets and furnishings. It should also be noted that all fixtures and fittings, carpeted, curtains/blinds, kitchen equipment and garden statuary, whether fitted or not, are deemed removable by the vendor unless specifically itemised with these particulars.

Hamptons City Lettings

Aldermay House 15 Queen Street

London EC4N 1TX

Tel: 020 7236 8399 - citylettings@hamptons-int.com

www.hamptons.co.uk

HAMPTONS
INTERNATIONAL

Beyond your expectations