



Leinster Square London W2

£595 Per Week - Available 25/04/2017

HAMPTONS
INTERNATIONAL

Beyond your expectations

A beautiful apartment overlooking Leinster Square gardens in this stunning first floor period conversion with character features and plenty of charm and light.

Wood Floors | Good Storage | Balcony | Communal Gardens | Period Conversion | First Floor.

Description

Call us between our extended opening hours of 6 - 9PM Monday to Thursday to arrange an appointment. Overlooking beautiful communal gardens this elegant Georgian first floor apartment benefits from direct access as well as a private terrace. With lovely high ceilings, lots of natural light and period features the apartment offers timeless charm, yet contemporary finish. There is a stunning reception room, compact but modern shower room and great storage. Located on a pretty square just off fashionable Westbourne Grove, this rare one bed is ideal for a couple or single professional.

Situation

Leinster Square is perfectly located for Hyde Park and the vibrant shops, cafes and restaurants

dotted along Westbourne Grove and Queensway. Waitrose supermarket and Whiteleys shopping/ cinema complex are a firm favourite with local residents. Excellent transport links are on the doorstep with Queensway (Central Line) and Bayswater (District and Circle lines) underground stations a short walk away.

Furnishing

Furnished



Kitchen



Bedroom

Hamptons Notting Hill Lettings

301 Westbourne Grove, Notting Hill
London W11 2QA

Tel: 020 7034 0405 - nottinghilllettings@hamptons-int.com

www.hamptons.co.uk

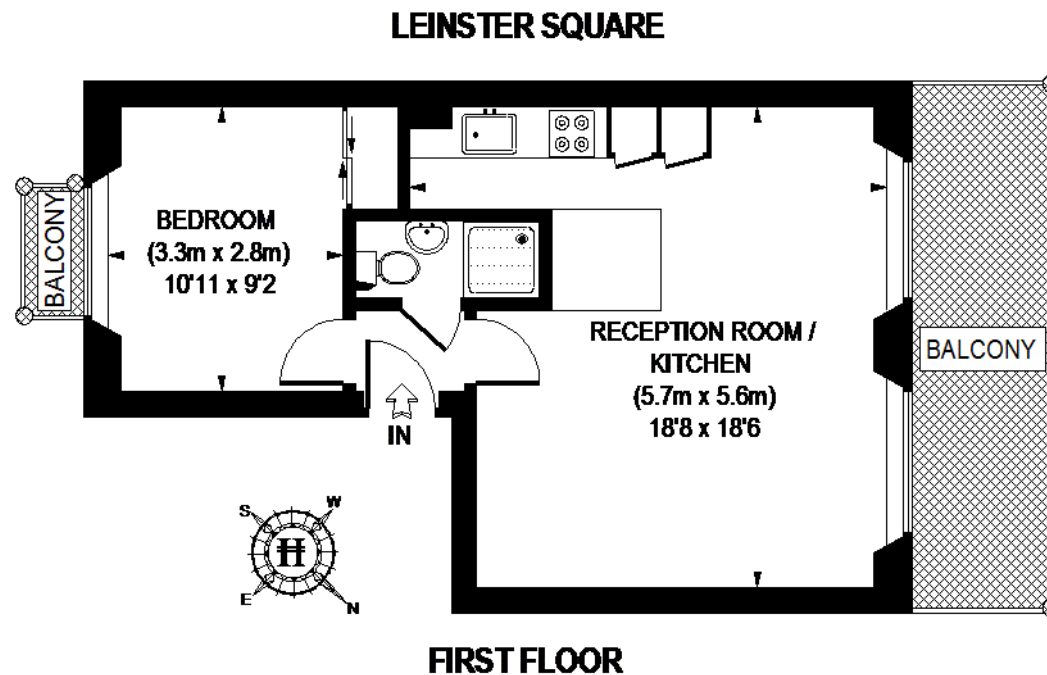

APPROXIMATE GROSS INTERNAL AREA = 452 SQ. FT. (42 SQ. M.)

This plan is for layout guidance only. Not drawn to scale unless stated. Windows & door openings are approximate. Whilst every care is taken in the preparation of this plan, please check all dimensions, shapes & compass bearings before making any decisions reliant upon them.

Please be advised that Hamptons International / our agents have not seen or reviewed any building regulations or planning permission in relation to works carried out to the property. (ID103064)

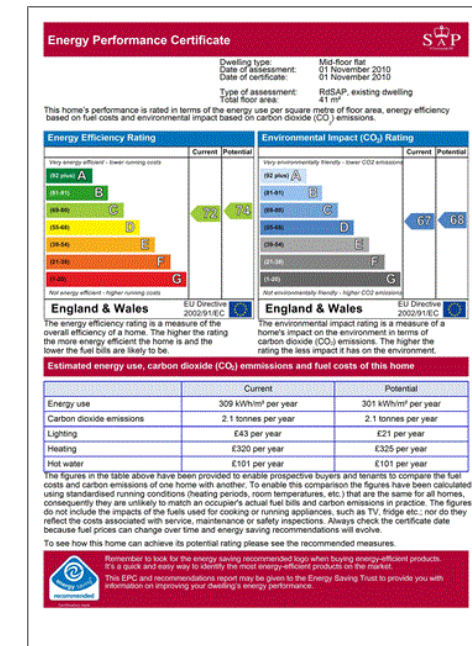

For clarification, we wish to inform prospective purchasers that we have prepared these sales particulars as a general guide. We have not verified permissions, nor carried out a survey, tested the services, appliances and specific fittings. Room sizes are approximate and rounded: they are taken between internal wall surfaces and therefore include cupboards/shelves, etc. Accordingly, they should not be relied upon for carpets and furnishings. It should also be noted that all fixtures and fittings, carpeted, curtains/blinds, kitchen equipment and garden statuary, whether fitted or not, are deemed removable by the vendor unless specifically itemised with these particulars.