



Meadvale Horsham RH12

£1,245 Per Month - Available 17/10/2016

**HAMPTONS**  
INTERNATIONAL

*Beyond your expectations*

*A very well presented fully furnished 3 bedroom end of terrace house. Situated a short walk from Tanbridge House School and Horsham Town Centre. EPC: D*

Kitchen/Breakfast Room | Sitting Room | 3 Bedrooms | 1 Bathroom | Enclosed Garden | Fully Furnished.

### Description

A fully furnished 3 bedroom end of terrace house. The property comprises porch with access to a large living room, kitchen/dining room with breakfast bar and access to the rear garden. The first floor comprises landing with access to a large master bedroom with built in wardrobes, two further bedrooms and family white suite bathroom with a separate shower. The property is very well presented and has been decorated with neutral colours throughout.

### Situation

Meadvale is situated just off Hills Farm Lane in Horsham which is convenient location for Tanbridge House School and a short walk from Horsham which offers a wide range of shops, restaurants and leisure facilities including

Pavilion Leisure Centre. Horsham also offers mainline train station which offers regular services to London and the South Coast. By car the Meadvale is a short drive from A24 offering easy access to Dorking, Gatwick Airport and the national motorway network.

### Furnishing

Furnished



### Hamptons Horsham Lettings

64 West Street

Horsham RH12 1PL

Tel: 01403 254877 - [horshamlettings@hamptons-int.com](mailto:horshamlettings@hamptons-int.com)

[www.hamptons.co.uk](http://www.hamptons.co.uk)

## Floorplan

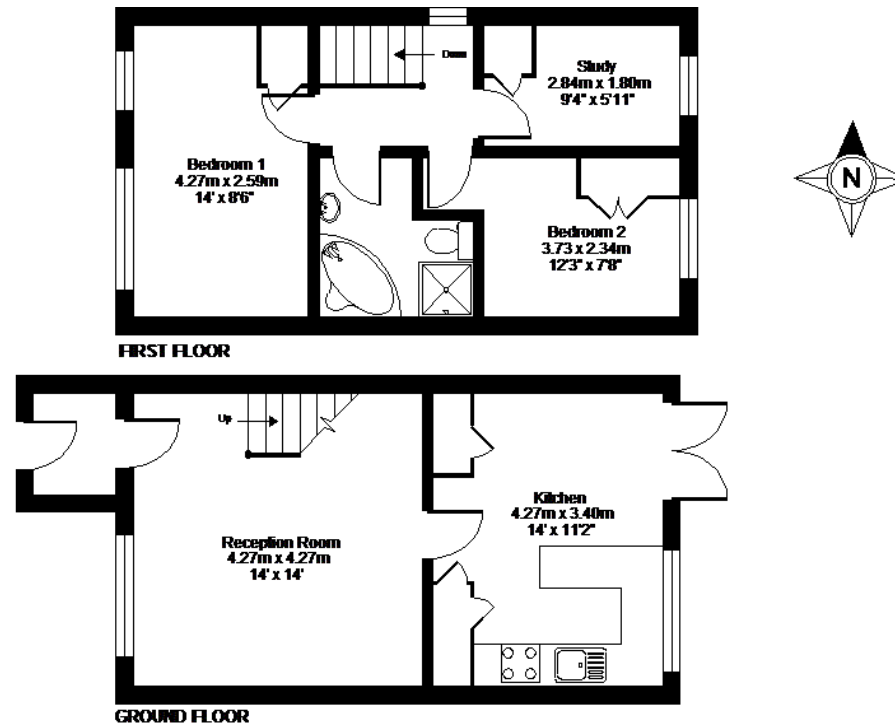

**Meadvale, Horsham, RH12**

**APPROX. GROSS INTERNAL FLOOR AREA 753 SQ FT 69.95 SQ METRES**

Whilst every attempt has been made to ensure the accuracy of the floor plan contained here, measurements of doors, windows and rooms are approximate and no responsibility is taken for any error, omission or misstatement. These plans are for representation purposes only as defined by RICS Code of Measuring Practice and should be used as such by any prospective purchaser. Specifically no guarantee is given on the total square footage of the property if quoted on this plan. Any figure given is for information only and should not be relied on as a basis of valuation.

Copyright nichecom.co.uk 2014. Produced for Hamptons Country Lettings REF : 571582

## Energy Performance Certificate (EPC)

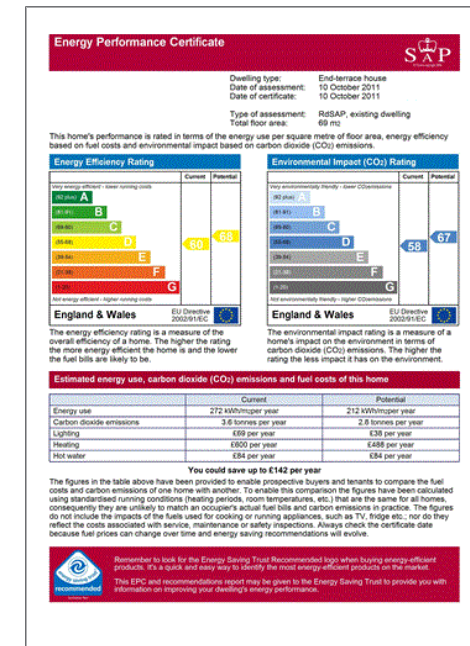

**For clarification,** we wish to inform prospective purchasers that we have prepared these sales particulars as a general guide. We have not verified permissions, nor carried out a survey, tested the services, appliances and specific fittings. Room sizes are approximate and rounded: they are taken between internal wall surfaces and therefore include cupboards/shelves, etc. Accordingly, they should not be relied upon for carpets and furnishings. It should also be noted that all fixtures and fittings, carpeted, curtains/blinds, kitchen equipment and garden statuary, whether fitted or not, are deemed removable by the vendor unless specifically itemised with these particulars.

## Hamptons Horsham Lettings

64 West Street

Horsham RH12 1PL

Tel: 01403 254877 - horshamlettings@hamptons-int.com

[www.hamptons.co.uk](http://www.hamptons.co.uk)

**HAMPTONS**  
INTERNATIONAL

*Beyond your expectations*