

Waterside



Portsmouth Road Kingston upon Thames KT1

£1,650 Per Month - Available Now

HAMPTONS
INTERNATIONAL

Beyond your expectations

Portsmouth Road Kingston upon Thames KT1

£1,650 Per Month - Available Now

HAMPTONS
INTERNATIONAL

Superb two bedroom apartment situated in a popular development close to Kingston town centre.

Apartment | Reception | Kitchen | Two bedrooms | Bathroom | Terrace | Communal Gardens | Private garage | River views.

Description

Superb two bedroom apartment with spacious accommodation throughout including a bright reception room with parquet wood floors and doors opening out onto a terrace, modern kitchen with integrated appliances and dining area, two generous double bedrooms and a family bathroom. Further benefits include use of communal gardens and a private garage. The property is located close to the River Thames and within walking distance to Kingston mainline station.

Furnishing

Unfurnished



Bedroom

Hamptons Kingston Lettings

40 High Street

Kingston KT1 1HL

Tel: 020 8546 3322 - kingstonlettings@hamptons-int.com

www.hamptons.co.uk

Floorplan

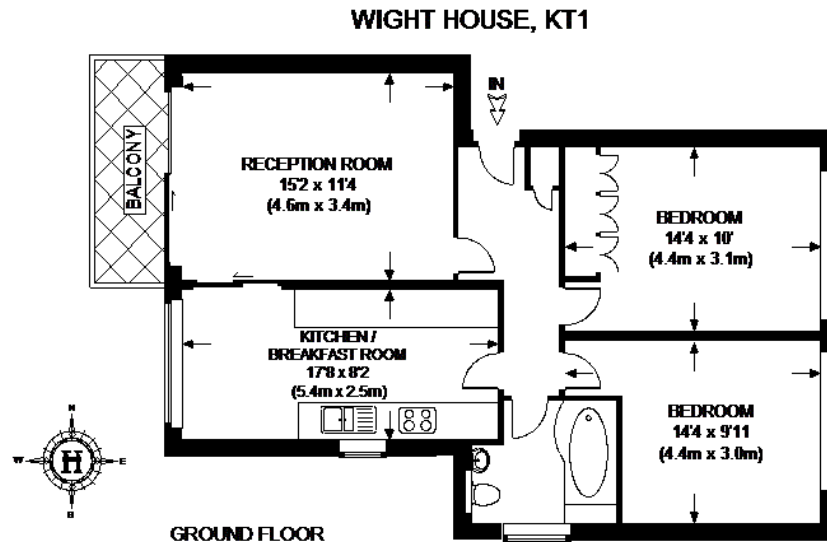

APPROXIMATE GROSS INTERNAL AREA = 732 SQ.FT. (68 SQ. M.)

This plan is for layout guidance only. Not drawn to scale unless stated. Windows & door openings are approximate. Whilst every care is taken in the preparation of this plan, please check all dimensions, shapes & compass bearings before making any decisions reliant upon it. Please be advised that Hamptons International / our agents have not seen or reviewed any building regulations or planning permission in relation to works carried out to the property.

Energy Performance Certificate (EPC)

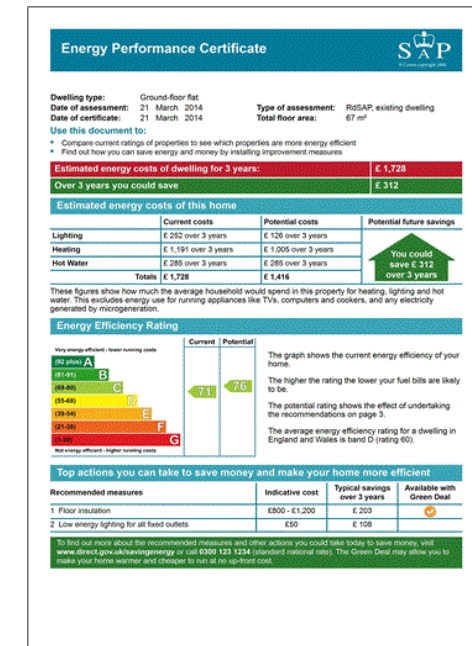

For clarification, we wish to inform prospective purchasers that we have prepared these sales particulars as a general guide. We have not verified permissions, nor carried out a survey, tested the services, appliances and specific fittings. Room sizes are approximate and rounded: they are taken between internal wall surfaces and therefore include cupboards/shelves, etc. Accordingly, they should not be relied upon for carpets and furnishings. It should also be noted that all fixtures and fittings, carpeted, curtains/blinds, kitchen equipment and garden statuary, whether fitted or not, are deemed removable by the vendor unless specifically itemised with these particulars.

Hamptons Kingston Lettings

40 High Street

Kingston KT1 1HL

Tel: 020 8546 3322 - kingstonlettings@hamptons-int.com

www.hamptons.co.uk

HAMPTONS
INTERNATIONAL

Beyond your expectations