



Wadbrook Street Kingston upon Thames KT1

£2,300 Per Month - Available 29/09/2016

HAMPTONS
INTERNATIONAL

Beyond your expectations

Wadbrook Street Kingston upon Thames KT1

£2,300 Per Month - Available 29/09/2016

HAMPTONS
INTERNATIONAL

A modern two bedroom, two bathroom apartment with stunning river views.

Two bedroom | Two bathroom | Spacious lounge | 24 hr Concierge | Underground parking | Close to all amenities and transportation.

Description

Call us between our extended opening hours of 6 - 10PM Monday to Thursday to arrange an appointment. A modern two bedroom, two bathroom apartment with stunning river views. This property offers underground parking and a 24 hour concierge and is situated in Central Kingston within walking distance to all local shopping centres and transport links. The property is available unfurnished for £2,100pcm or furnished for £2,300pcm. A viewing is highly recommended.

Furnishing

Unfurnished



Ravens-House-Wadbrook-Street-003



Ravens-House-Wadbrook-Street-008

Hamptons Kingston Lettings

40 High Street

Kingston KT1 1HL

Tel: 020 8546 3322 - kingstonlettings@hamptons-int.com

www.hamptons.co.uk

Floorplan

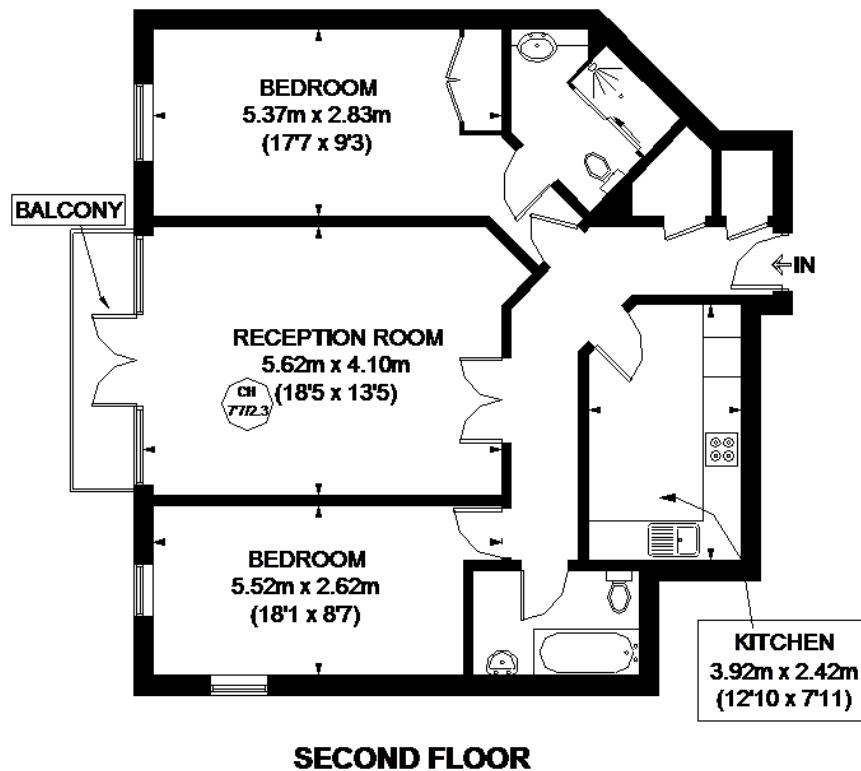

RAVENS HOUSE



APPROXIMATE GROSS INTERNAL AREA
935 SQ. FT. (86.9 SQ. M.)



This plan is for layout guidance only. Not drawn to scale unless stated. Windows and door openings are approximate. Whilst every care is taken in the preparation of this plan, please check all dimensions, shapes and compass bearings before making any decisions reliant upon them. Please be advised that Hamptons International / our agents have not seen or reviewed any building regulations or planning permission in relation to works carried out to the property (03228457).

Energy Performance Certificate (EPC)

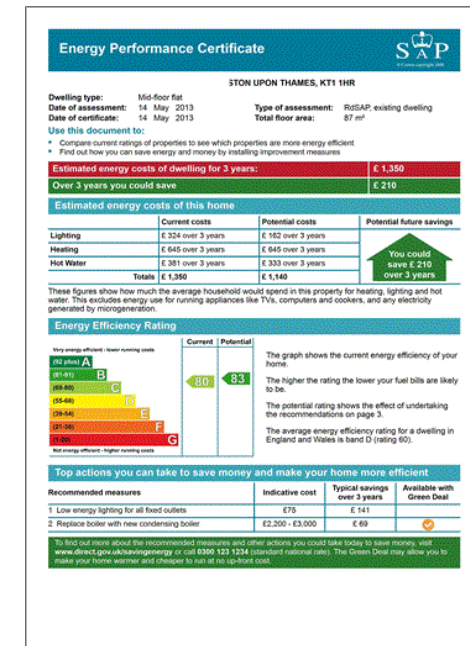

For clarification, we wish to inform prospective purchasers that we have prepared these sales particulars as a general guide. We have not verified permissions, nor carried out a survey, tested the services, appliances and specific fittings. Room sizes are approximate and rounded: they are taken between internal wall surfaces and therefore include cupboards/shelves, etc. Accordingly, they should not be relied upon for carpets and furnishings. It should also be noted that all fixtures and fittings, carpeted, curtains/blinds, kitchen equipment and garden statuary, whether fitted or not, are deemed removable by the vendor unless specifically itemised with these particulars.

Hamptons Kingston Lettings

40 High Street

Kingston KT1 1HL

Tel: 020 8546 3322 - kingstonlettings@hamptons-int.com

www.hamptons.co.uk

HAMPTONS
INTERNATIONAL

Beyond your expectations