



1/1, 15 Braehead Road, Paisley, Renfrewshire, PA2 8DZ



A seldom available three bedroom first floor flat of a two story building within a desirable and sought after residential district of Glenburn. The accommodation is accessed via security door entry which only services the ground floor and first floor apartments. The property is spacious and occupies a substantial corner plot. The well presented accommodation on offer comprises of a welcoming reception hallway incorporating storage. The lounge/dining area is particularly spacious with access to the kitchen from both the dining area and the hallway. The three double bedrooms area all well proportioned and the accommodation is completed by the family bathroom.

The specification extends to gas central heating and double glazing. In addition there are attractive gardens to the front and rear. Early viewing of this superb property is strongly advised in order to avoid disappointment.

Please refer to published Home Report for EER band.





1/1, 15 Braehead Road, Paisley, Renfrewshire,
PA2 8DZ



To view contact:

Countrywide Paisley CWN
5 Causeyside Street, Paisley, Renfrewshire, PA1 1UW
Telephone: 0141 848 1155
e-mail: paisley@countrywidennorth.co.uk

Reference: PA1180484

Office opening hours:
Mon & Tue: 9.00am - 5.30pm
Wed & Thu: 9.00am - 7.00pm
Fri: 9.00am - 5.00pm
Sat: 9.00am - 1.00pm

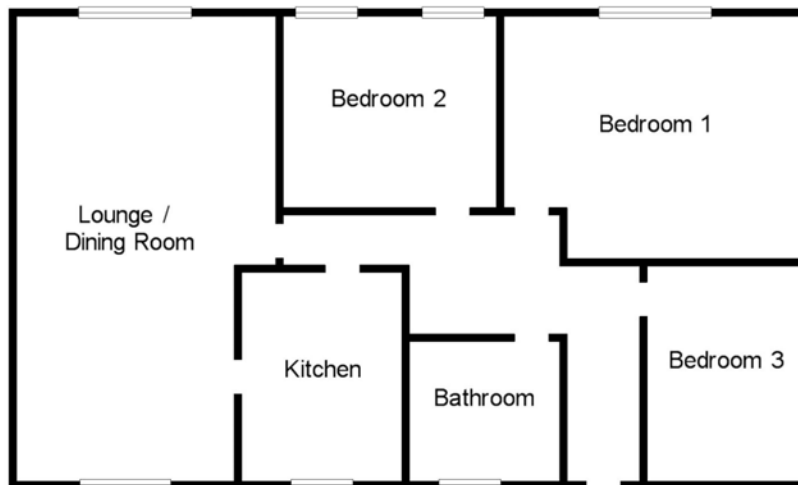

ACCOMMODATION

LOUNGE/DINING ROOM - 20'8" x 11'2" (6.3m x 3.4m)

KITCHEN - 10'1" x 7'10" (3.07m x 2.39m)

BEDROOM 1 - 15'2" x 9'8" (4.62m x 2.95m)

BEDROOM 2 - 13'6" x 8'7" (4.11m x 2.62m)

BEDROOM 3 - 9' x 8'3" (2.74m x 2.51m)

BATHROOM - 6'1" x 5'7" (1.85m x 1.7m)

www.countrywidescotland.co.uk